

INDICATIVE MEASUREMENTS OF ROPE RIVETS STANDARD SERIES

Ø RIVETS MM	2,4	2,9	3,2	3,4	3,9	4,9	5,9	6,4	7,8
RIVET HEAD MM	5	6	6,5	7	8	10	12	12	14

2

Blind rivets in aluminum



- Rivets in aluminum alloy with galvanized steel nail.
- Dimensions d x L: see description of the price list.

Code	Description dxL
38500****	See price list

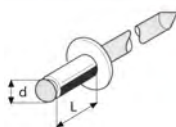

**** sizes: see price list

Aluminum rivets with large head



- Blind rivets in aluminum alloy head with large 16 mm galvanized steel nail.

Code	Desc. dxL-T	Tigh. thickness. mm
385TL00050	4,8x12-T16	6÷8
385TL00100	4,8x16-T16	10÷12
385TL00200	4,8x20-T16	14÷16
385TL00250	4,8x26-T16	20÷22
385TL00600	5,8x14-T16	8÷10

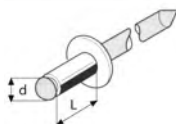

Blind rivets aluminum colored RAL

2



- Aluminum rivets painted with nail galvanized steel.
- Available in RAL colors most used in fixtures.

Code	Desc. dxL	Color	Spess. serr. mm
3850B03000	2,9x8/B mm	White RAL 9010	3÷5
3850B03100	2,9x10/B mm	White RAL 9010	5÷7
3850B03200	2,9x12/B mm	White RAL 9010	7÷9
3850B03300	3,9x10/B mm	White RAL 9010	5÷6,5
3850B03400	3,9x12/B mm	White RAL 9010	7÷8,5
3850B03500	3,9x16/B mm	White RAL 9010	10÷12,5
3850B03600	4,8x10/B mm	White RAL 9010	4,5÷6
3850B03700	4,8x12/B mm	White RAL 9010	6,5÷8
3850B03800	4,8x16/B mm	White RAL 9010	9,5÷12
3850B04000	2,9x8/N mm	Black RAL 9005	3÷5
3850B04100	2,9x10/N mm	Black RAL 9005	5÷7
3850B04200	2,9x12/N mm	Black RAL 9005	7÷9
3850B04300	3,9x10/N mm	Black RAL 9005	5÷6,5
3850B04400	3,9x12/N mm	Black RAL 9005	7÷8,5
3850B04500	3,9x16/N mm	Black RAL 9005	10÷12,5
3850B04600	4,8x10/N mm	Black RAL 9005	4,5÷6
3850B04700	4,8x12/N mm	Black RAL 9005	6,5÷8
3850B04800	4,8x16/N mm	Black RAL 9005	9,5÷12
3850B05000	2,9x8/T mm	Brown RAL 8017	3÷5
3850B05300	3,9x10/T mm	Brown RAL 8017	5÷6,5
3850B05400	3,9x12/T mm	Brown RAL 8017	7÷8,5
3850B05500	3,9x16/T mm	Brown RAL 8017	10÷12,5
3850B05600	4,8x10/T mm	Brown RAL 8017	4,5÷6
3850B05700	4,8x12/T mm	Brown RAL 8017	6,5÷8
3850B05800	4,8x16/T mm	Brown RAL 8017	9,5÷12
3850B06000	2,9x8/V mm	Green RAL 6005	3÷5
3850B06100	2,9x10/V mm	Green RAL 6005	5÷7
3850B06200	2,9x12/V mm	Green RAL 6005	7÷9
3850B06300	3,9x10/V mm	Green RAL 6005	5÷6,5
3850B06400	3,9x12/V mm	Green RAL 6005	7÷8,5
3850B06500	3,9x16/V mm	Green RAL 6005	10÷12,5
3850B06600	4,8x10/V mm	Green RAL 6005	4,5÷6
3850B06700	4,8x12/V mm	Green RAL 6005	6,5÷8
3850B06800	4,8x16/V mm	Green RAL 6005	9,5÷12

Blind rivets anodized blacks

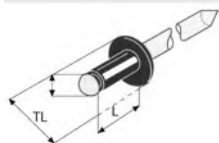

Code	Desc. dxL-T	Tigh. thickness. mm
3900N00050	3,2x11 - T6,5	6÷8
3900N00150	3,2x16 - T6,5	11÷13
3900N00240	3,8x11 -	6,5÷7,5
3900N00242	3,8x14 - TL12	8,5÷10,5
3900N00245	3,8x16 -	10,5÷12,5
3900N00300	4,8x9 -	4÷5
3900N00305	4,8x12 - TL16	7÷8
3900N00310	4,8x14 -	8÷10
3900N00400	4,8x16 - TL16	10÷12
3900N00500	4,8x25 - TL16	20÷22

- Rivets, anodized aluminum alloy ALMg3,5 blacks with galvanized steel nail.
- Required in the automotive industry, such a rivet is indicated in particular for the fixing of the grille, the upholstery and dashboard of cars.

Galvanized steel rivets

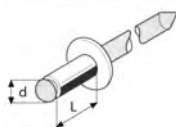

- Blind rivets made of galvanized steel with steel nail

Code	Desc. D x L	Tigh. thickness. mm
4010003600	4,8x16	9,5÷12
4010003700	4,8x18	11,5÷14
4010004300	5,8x18	9,5÷13
4010004400	5,8x22	12,5÷17

Blind rivets stainless steel

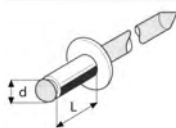

Code	Desc. D x L	Tigh. thickness. mm
3870000100	3,2x5	0,5÷3
3870000300	3,2x9	4÷6
3870000500	3,9x7	2÷3,5
3870000600	3,9x9	3÷5,5
3870000700	3,9x11	5÷7,5
3870000800	3,9x12	7÷8,5
3870000850	3,9x14	8÷10,5
3870000900	3,9x16	10÷12,5
3870000902	3,9x18	12÷14,5
3870000980	4,8x7	0,5÷3
3870001000	4,8x9	2,5÷5
3870001100	4,8x12	5,5÷8
3870001200	4,8x15	9,5÷12
3870001300	4,8x18	11,5÷14
3870001400	4,8x20	13,5÷16

- Rivets alloy steel Cu 80% Ni 20% with stainless steel nail.

Copper blind rivets

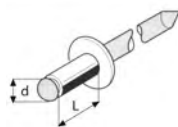

- Copper rivets with natural nail galvanized steel.
- DIN 7337.

Code	Desc. D x L	Tigh. thickness. mm
3900000040	2,9x9	4÷6
3900000058	2,9x16	11÷13
3900000090	3,2x7	2÷4
3900000095	3,2x11	6÷8
3900000100	3,4x5	0,5÷2
3900000200	3,4x7	2÷4
3900000300	3,4x9	4÷6
3900000400	3,4x11	6÷8
3900000502	3,4x14	8÷11
3900000504	3,4x16	11÷13
3900000506	3,4x18	13÷15
3900000518	3,9x9	3,5÷5,5
3900000520	3,9x11	5,5÷7,5
3900000526	3,9x16	10,5÷12,5
3900000528	3,9x18	12,5÷14,5
3900000530	3,9x20	14,5÷16,5
3900000538	3,9x30	21,5÷26,5
3900000545	4,8x12	5,5÷8
3900000550	4,8x16	10÷12
3900000900	4,8x30	19,5÷26

Aluminum rivets graf



- Rivets graf aluminum AlMg 3.5 with galvanized steel nail.
- This rivet is particularly suitable for fastening of any object on soft materials such as plastic, leather, cardboard, wood, hollow bricks etc. The rivet bushing opens in most parts during fastening thus assuring an optimal combination also on uneven surfaces.

Code	Desc. D x L	Tigh. thickness. mm
3890000100	3,9x12	3÷6
3890000200	3,9x16	6÷10
3890000300	3,9x20	10÷14
3890000400	3,9x24	14÷18
3890000600	3,9x30	18÷24
3890000700	4,8x16	5÷10
3890000900	4,8x24	14÷18
3890001100	4,8x30	18÷22
3890001200	4,8x35	22÷27
3890001300	4,8x40	27÷32
3890001400	4,8x45	32÷37
3890001500	4,8x50	37÷42

Graf aluminum rivets wide headed anodized blacks



- Rivets in aluminum alloy AlMg 3.5 large head anodized blacks with galvanized steel nail.
- This rivet graf wide head allows a more uniform distribution of pressure in such a way as to make the rivet particularly suitable in the automotive industry for the attachment of any object on soft materials such as plastic, wood, etc.

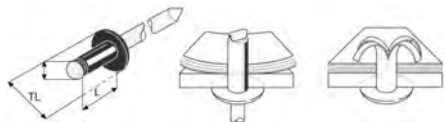

Code	Desc. D x L	Tigh. thickness. mm
389TL00300	4x20-T14	10÷14
389TL00800	4,8x20-T16	10÷16
389TL00900	4,8x25-T16	14÷18

Assortment aluminum rivets



- Contents: 16 bars of aluminum rivets by 2,9x5 to 6,4x25.
- Total 486 pieces.
- Supplied in a plastic carrying case n / s cod. 398 00 01900 ABH4.

Code	Desc.
3850100100	16

Content kit

CODE	DESCRIPTION	PCS
385 00 00100	2.9X5	50
385 00 00400	2.9X11	50
385 00 01000	3.2X18	25
385 00 01200	3.4X7	25
385 00 01500	3.4X14	25
385 00 02200	3.9X20	25
385 00 02400	4.9X10	25
385 00 03000	4.9X22	25
385 00 03600	5.9X32	12,5
385 00 03800	6.4X16	12,5
385 00 04000	6.4X25	12,5
385 00 00700	3.2X9	50
385 00 00900	3.2X14	50
385 00 03400	5.9X18	25
385 00 00200	2.9X7	50
385 00 01900	3.9X14	25

Blind rivets Trimecc



- Blind rivets in aluminum with round head and nail aluminum.
- Suitable for irregular holes and soft materials and pliable as plastic, plywood etc. the expansion creates a good anchorage therefore it is not necessary to interpose a washer.



Code	Desc. D x L	Tigh. thickness. mm
5060000100	4x14	1÷4
5060000200	4x19	1÷7
5060000300	4,8x15	1÷4
5060000400	4,8x20	1÷9
5060000410	4,8x25	3÷11

Trimecc rivets



Code	Description dxL	Tigh. thickness. mm
506TA00100	4X16-Blue Ral 5017	1-4
506TA00300	4X16-Grey Ral 7035	1-4
506TA00500	4X16-Black Ral 9005	1-4
506TA00700	4X19-Blue Ral 5017	1-7
506TA00900	4X19-Grey Ral 7035	1-7
506TA01100	4X19-BlackRal 9005	1-7
506TA01600	4,8X16-Grey Ral 7035	1-4
506TA01700	4,8x20-Blue Ral 5017	1-9
506TA01800	4,8X20-Grey Ral 7035	1-9
506TA01900	4,8X20-Black Ral 9005	1-9
507TA02300	4,8x20 WhiteRal 9010	1-9

- Aluminum rivets to 3 fins, round head with nail aluminum, specific for fastening piaste and in the bodywork (black color).

Aluminum rivets countersunk head

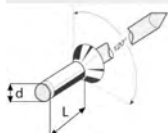

Code	Desc. D x L	Tigh. thickness. mm
3880000100	3,2x7	2÷4
3880000110	3,2x9	4÷6
3880000120	3,2x11	6÷8
3880000130	3,2x13	8÷11
3880000150	3,9x9	3,5÷6
3880000170	3,9x12	7,5÷9
3880000190	3,9x16	10,5÷13
3880000200	3,9x18	12,5÷15
3880000210	3,9x20	14,5÷17
3880000230	4,8x9	3,5÷5
3880000250	4,8x12	6,5÷8
3880000260	4,8x14	7,5÷10
3880000270	4,8x16	9,5÷12
3880000280	4,8x18	11,5÷14
3880000290	4,8x20	13,5÷16

- Blind rivets in aluminum alloy AIMg 3.5 countersunk head with galvanized steel nail.

Graf rivets

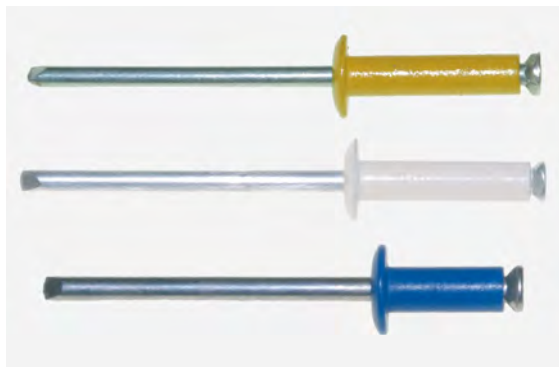

- Rivets graf painted aluminum

Code	Desc. dxL	Color
3890002200	4,8x20	Yellow
3890001910	4x16-T10	Yellow
3890002300	4,8x20	White
3890001922	4x16-T10	White
3890001930	4x16-T12	Blue

Plastic Blind rivets



- Blind rivets with nylon body and black nail black acetate.
- Highest accuracy and quality construction.
- They are used to fix plastic on plastic, plastic on metal and plastic on the glass fiber.
- It does not damage painted surfaces or other brittle materials.
- Non-conductive, does not transmit electrical charges
- It does not rust

Code	Desc dxLxTL	Tigh. thickness. mm
506PL00100	5x20-TL12	3,0-6,0
506PL00200	5x25-TL12	6,0-10,0
506PL00300	6,3x18-TL17	4,0-6,0
506PL00400	6,3x28-TL17	4,0-10,0

Riveting tool for blind rivets in plastic



- Riveting tool fitting for plastic rivets.
- Very compact, long nose is what professionals need to work in parts difficult to reach, especially in the bodywork, bumpers, wheel arches, on license plates.
- This riveting Meccanocar fixed the rivet with a single movement and having a universal nozzle can be used with all sizes of rivets.
- By working in a straight line with the rivet (no angle of 90 °) it is possible to impart a greater force on the material to be fastened.

Code	Desc.
506PL01000	10R

Kit Riveter with rivets plastic



- Contents: 4 rivets measures:
- 25 pieces 6.3 x 28 x 17
- 25 pieces 6.3 x 18 x 17
- 25 pieces of 5 x 25 x 12
- 25 pieces of 5 x 20 x 12
- Riveting manual art. 506PL01000 - 10R.
- Total 101 pieces.
- Practical plastic case.

Code	Desc.
506PL02000	KIT

Il sistema Monobolt

IL SISTEMA MONOBOLT E' PARTICOLARMENTE ADATTO PER APPLICAZIONI SU COMPONENTI SOGGETTI A VIBRAZIONI, PUO' SOSTITUIRE LE TECNOLOGIE TRADIZIONALI COME DADO-BULLONE, RIBATTINI SOLIDI E SALDATURA. QUESTO RIVETTO SI APPLICA CON UN ATTREZZO OLEOPNEUMATICO RIUSCENDO AD ASSEMBLARE COMPONENTI CON SPESSORI DIVERSI. IL RIVETTO MONOBOLT E' DISPONIBILE CON Ø 4,8 E 6,4 mm IN MATERIALI DIVERSI: ACCIAIO - ALLUMINIO - INOX E NELLE VERSIONI A TESTA TONDA E SVASATA

Come funziona

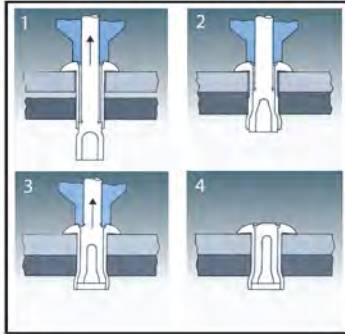

- 1) IL BULLONE MONOBOLT GIA' INSERITO NEL NASELLO DELL'ATTREZZO VIENE INTRODOTTO NEL FORO DEI COMPONENTI DA ASSEMBLARE
- 2) AZIONANDO L'ATTREZZO IL GAMBO SUBISCE UNA TRAZIONE, LA TESTA DELLO STESSO TRAFILA IL CORPO: OTTENIAMO COSI' L'AVVICINAMENTO DEI COMPONENTI
- 3) CONTINUANDO L'AZIONE DI TRASCINAMENTO DEL GAMBO OTTENIAMO IL COMPLETO RIEMPIMENTO DEL FORO
- 4) QUANDO LA SEZIONE MAGGIORE DEL GAMBO CONTRASTA IL NASELLO DELL'ATTREZZO, IL GAMBO STESSO SI ROMPE NEL PUNTO PRESTABILITO (A FILO DI TESTA)



Bloccaggio del gambo

UNA DELLE CARATTERISTICHE PRINCIPALI DEL MONOBOLT CONSISTE NEL BLOCCAGGIO MECCANICO DEL GAMBO, CONDIZIONE INDISPENSABILE PER GARANTIRE UNA GIUNZIONE DI TIPO STRUTTURALE

Monobolt rivets round head (TT) and countersunk head (TS) aluminum

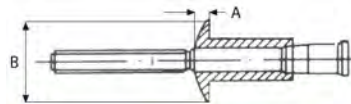

TIPO DI MATERIALE	
CORPO	5056 - 0 DIN AL Mg 5% No. 3.3555
GAMBO	2014 - T6 DIN AL CU S. Mn 3.1255

DATI TECNICI			
Ø BULLONE	CARICHI (N)		
	TAGLIO	TRAZIONE	ESPULSIONE GAMBO
4,8	3002	2224	222
6,4	6005	4226	445

Code	Desc.	Tigh. thickness. mm	Ø recom. hole	A	B
410AL00100	4,8x14 TT	1,6 - 11,1	4,9 - 5,1	1,7 - 2,1	9,5 - 10
410AL00150	6,4x15 TT	2,0 - 9,5	6,6 - 7,0	2,4 - 2,9	12,8 - 13,3
410AL00200	6,4x20 TT	2,0 - 15,9	6,6 - 7,0	2,4 - 2,9	12,8 - 13,3
410AL00350	6,4x17 TS	2,0 - 9,5	6,6 - 7,0	2,4 - 2,9	12,8 - 13,3

Monobolt rivets round head (TT) Steel A2

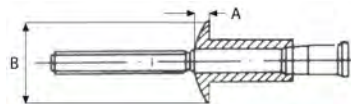

TIPO DI MATERIALE	
CORPO	AISI 304 (+ 3-4% Cu)
GAMBO	AISI 304 (+ 3-4% Cu)

DATI TECNICI			
Ø BULLONE	CARICHI (N)		
	TAGLIO	TRAZIONE	ESPULSIONE GAMBO
4,8	6449	5115	444
6,4	11787	10453	1112

Code	Desc.	Tigh. thickness. mm	Ø recom. hole	A	B
410A200800	4,8x13 TT	1,6 - 6,9	4,9 - 5,1	1,7 - 2,1	9,5 - 10
410A200850	4,8x14 TT	1,6 - 11,1	4,9 - 5,1	1,7 - 2,1	9,5 - 10
410A200900	6,4x15 TT	2,0 - 9,5	6,6 - 7,0	2,4 - 2,9	12,8 - 13,3
410A200950	6,4x20 TT	2,0 - 15,9	6,6 - 7,0	2,4 - 2,9	12,8 - 13,3

Riveting machines for blind rivets



- New manual riveting machine for rivet D.2.4-4.8 (aluminum only).
- With the system of detention nail.
- Weight 0.530 kg.
- Small footprint.

Code	Description	Range
3950000110	1/B	2.4 - 4.8
3850004160	A10 Replacement kits clamps	-

Riveting tool manual long



- For rivet D.2,4-4,8 all leagues
- Spring Return
- With long levers for the relief effort in the draw of the rivets

Code	Description	Range
3950000110	1/B	2,4 - 4,8
3850004160	A10 Replacement kits clamps	-

Riveting tool at rotating head

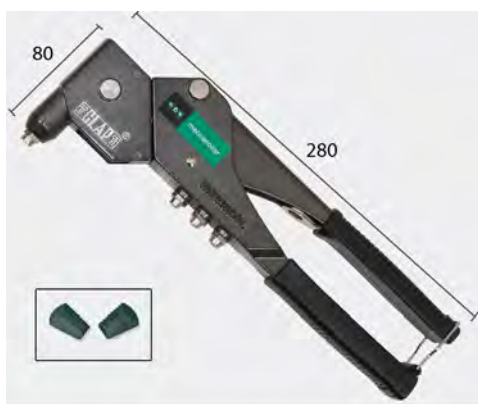

- For rivet 2.4 to 4.8 only aluminum and copper.
- Swivel head 360°.
- Suitable for working in confined spaces and not accessible by normal riveting.
- The riveting head swivel his catatteristiche is pretty tough draw in the rivet.
- Not suitable for intensive use and continuous.



Code	Description	Range
3950000301	3/1	2,4-4,8
3950000302	KIT TERMINALS	Clamp kit parts (2 pcs)

Riveting long levers

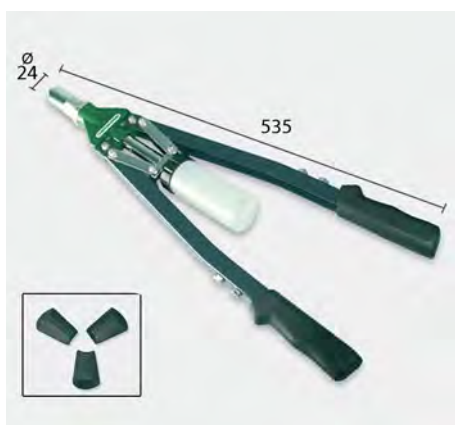

- For rivet D.3.2-6.4 all leagues + D.7.8 only aluminum rivets.
- Weight 1.80 kg.
- With tank for the recovery of the nail veneer.
- To use continuous and hard.

Code	Description	Range
3950000200	2	3,2-6.4+7.8 all
3850004110	A4-S Replacement kits clamps	-

2

Pneumatic riveting tool



- For rivet D.2.4-5 (only aluminum).
- Particularly handy.

Code	Description	Range
3950000310	4	2.4-5 (aluminum only)
3850004110	A4-S Replacement kits clamps	-

Riveter oleopneumatic



- For rivet 2.4 to 4.8 all leagues
- Riveting tool balanced for continuous thanks to the lack of effort on the button for the operator
- With swivel connector mounted
- Air connection 1/4 "female gas

Code	Description	Range
3950000800	9	2.4 - 4.8 all leagues
3950000810	KIT TERMINALS 395/9	Clamp kit parts (2 pcs)

Riveting machine oleopneumatic



- For rivet 2.4 to 6.4 all leagues
- Used to pull the rivets Structural type Monobolt and Magna-lok
- Riveting tool balanced for continuous thanks to the lack of effort on the button for the operator
- For the use of structural rivets it is sufficient replacing the nozzle already supplied.
- With air connection 1/4 "female gas

Code	Description	Range
3950000900	10	2,4-6,4 All alloys
3950000910	CLAMPS KIT FOR 395/10	Spare clamp kit

Battery-powered riveting machine 18 Volts - 5 mm (6 mm Al)



- Powerful battery-powered riveting machine, robust and handy for processing any type of rivet in an easy and very quick manner, except structural ones, up to 5 mm diameter (6 mm only for aluminium rivets).
- Suitable for fixing applications in many tasks: metalwork, metal processing, construction and installation of window frames and buildings, car body shops, vehicle modifications, advertising hoarding, etc.
- Equipped with brushless motor to minimize maintenance, very strong metal gears, nail container, LED light for lighting the work point, hook for support and hook for belt attachment.
- The rivet retaining system, the ergonomic, balanced handle, the very easy replacement of the nozzles make it a handy tool. It is compatible with all Metabo 18 Volts battery packs so as to be perfectly interchangeable with the whole system.
- Supplied as standard: riveting machine, dual Lithium battery 18 Volts - 2.0 Ah, 4 nozzles for rivets, fast battery charger, case of stackable plastic material.

Code	Desc.
3950001000	NP18LTX

Technical Features	
Forza di tiraggio	10.000 N
Ø maximum rivets only in aluminum	6 mm
Ø rivets in all materials	2,4-5
Battery type	Li-Ion
Weight including batteries (kg)	2,2 Kg
Battery voltage	18 Volts
Battery capacity	2,0 Ah

Threaded rivets rubber

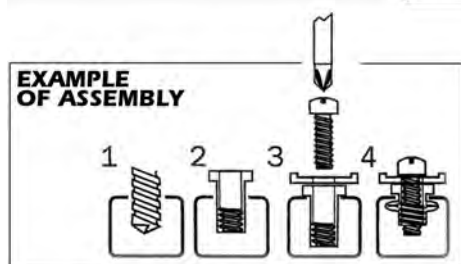
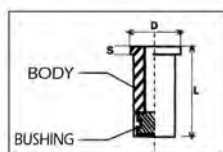

- Threaded tubular rivets rubber (Wellnut type).
- Antivibration.
- Particularly suitable for fixings subject to vibrations.
- Used on boxes or tubes.
- The neoprene body ensures chemical resistance, electrical insulation and soundproofing.
- The brass bushing ensures a good seal and good resistance to corrosion.
- Particularly suitable in the motorcycle sector for the attachment of the hulls and plastic details.

Code	Desc.	Spessore serr. ØxL	D head mm	Tthread	D. est. mm	Spess. testa mm	D. perforation mm
2930004006	4006-4x12,5	0,5-4,0	11	M4	7,9	1,4	8-8,3
2930004007	4007-5x14	0,5-5,0	12,7	M5	9,6	0,9	9,7-9,9
2930004008	4008-5x21,5	8,0-11,0	14	M5	9,6	0,9	9,7-9,9
2930004009	4009-5x26	8,0-16,0	14	M5	9,6	1,3	9,7-9,9
2930004010	4010-6x21	0,5-5,0	19	M6	12,7	4,7	12-13
2930004011	4011-6x26,5	6,0-11,0	26,5	M6	12,7	2,0	12,8-13

Threaded steel inserts



- Galvanized steel cylindrical threaded inserts, anti-twist screw, smooth or knurled body.
- Useful for making threads on sheet and small details

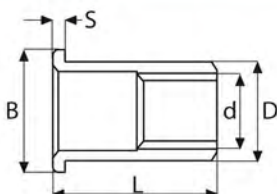

Code	Desc.	d mm	Spess. serr.	Ø foro	D mm	B mm	S mm	L mm	Model
4240001000	4 Z	M4	0,3/2,5	6	5,9	9	1,0	11,0	INSERTS KNURLED
4240001100	5 Z	M5	0,3/3,0	7	6,9	10	1,2	13,0	INSERTS KNURLED
4240001200	6 Z	M6	0,5/3,0	9	8,9	12	1,5	14,5	INSERTS KNURLED
4240001300	8 Z	M8	0,5/3,0	11	10,9	15	1,5	17,5	INSERTS KNURLED
4240000100	3	M3	0,3/1,8	5	4,9	7	0,8	9,0	INSERTS SMOOTH
4240000200	4	M4	0,3/2,5	6	5,9	9	1,0	11,0	INSERTS SMOOTH
4240000300	5	M5	0,5/3,0	7	6,9	10	1,2	13,0	INSERTS SMOOTH
4240000400	6	M6	0,5/2,3	9	8,9	12	1,5	14,5	INSERTS SMOOTH
4240000500	8	M8	0,8/3,5	11	10,9	15	1,5	17,5	INSERTS SMOOTH
4240000600	10	M10	1,0/3,5	12	11,9	16	1,7	19,0	INSERTS SMOOTH

Threaded inserts in aluminum

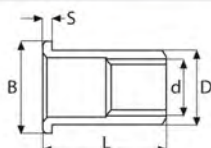

Code	Desc.	d mm	Spess. serr.	Ø foro	D mm	B mm	S mm	L mm
4250000100	3	M3	0,3/1,8	5	4,9	7	0,8	9
4250000200	4	M4	0,3/2,5	6	5,9	9	1	11
4250000300	5	M5	0,5/3	7	6,9	10	1,2	13
4250000400	6	M6	0,5/2,3	9	8,9	12	1,5	14,5
4250000500	8	M8	0,8/3,5	11	10,9	15	1,5	17,5
4250000600	10	M10	1/3,5	12	11,9	16	1,7	19

- Underhead knurled
- Threaded inserts in aluminum alloy cylinder head

Manual pulls inserts



- For female threaded inserts from M3 to M6.
- For aluminum, steel and stainless steel inserts.
- Supplied in a clear plastic bag.

Code	Desc.	Range
4250100700	901	M3 to M6

Replacement tie rods to clamp M3 to M6



Code	Description	For female inserts
4250100703	901-M3 tie-beam	M3
4250100704	901-M4 tie-beam	M4
4250100705	901-M5 tie-beam	M5
4250100706	901-M6 tie-beam	M6
4250100713	901-M3 head	M3
4250100714	901-M4 head	M4
4250100715	901-M5 head	M5
4250100716	901-M6 head	M6

- Tie rods and replacement brush heads from M3 to M6

Pulls inserts manual



- For female threaded inserts from M3 to M10
- For aluminum, steel and stainless steel inserts.
- With long levers to decrease operator fatigue.

Code	Desc.	Range
4250100800	903	M3 to M10

2

Replacement tie rods for M3 to M10 clip



Code	Description	For female inserts
4250100803	903-M3 tie rod	M3
4250100804	903-M4 tie rod	M4
4250100805	903-M5 tie rod	M5
4250100806	903-M6 tie rod	M6
4250100808	903-M8 tie rod	M8
4250100810	903-M10 tie rod	M10
4250100823	903-M3 head	M3
4250100824	903-M4 head	M4
250100825	903-M5 head	M5
4250100826	903-M6 head	M6
4250100828	903-M8 head	M8
4250100830	903-M10 head	M10

- Tie rods and replacement brush heads from M3 to M10
- For female inserts

Oleopneumatic pulls inserts



- For female threaded inserts from M3 to M12
- Air connection 1/4" female gas
- Threaded inserts for aluminum and steel including stainless steel
- Supplied in case

Code	Description	For female inserts
4250100600	RIVETING M3-M12	FROM M3 TO M12

Spare parts for hydraulic vacuum riveter

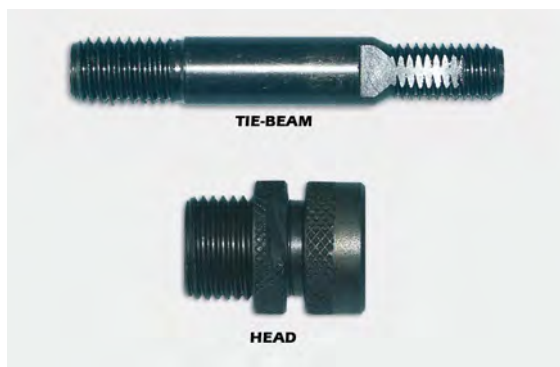

Code	Description	For female inserts
4250100603	TM3-TIE ROD	M3
4250100604	TM4-TIE ROD	M4
4250100605	TM5-TIE ROD	M5
4250100606	TM6-TIE ROD	M6
4250100608	TM8-TIE ROD	M8
4250100610	TM10-TIE ROD	M10
4250100612	TM12-TIE ROD	M12
4250100623	TG-M3-HEAD WITH BUSH	M3
4250100624	TG-M4-HEAD WITH BUSH	M4
4250100625	TG-M5-HEAD WITH BUSH	M5
4250100626	TG-M6-HEAD WITH BUSH	M6
4250100628	TG-M8-HEAD WITH BUSH	M8
4250100630	TG-M10-HEAD WITH BUSH	M10
4250100632	TG-M12-HEAD WITH BUSH	M12