

## Rotary burrs in hard metal

- Used for welding points and removal of metal chips.
- to long-term.
- With cross-cut to treated steel, stainless steel and all metal materials in general.
- Reduced vibration for the type of cut.
- Good surface finish.
- To be used with pneumatic grinders or drills.
- Speed 'recommended 450 to 600 m / min.

### Cylindrical-cut front

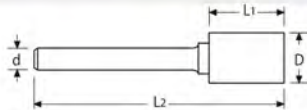

Code	Desc. D x L1	d x L2
4430047059	773 - 6x8	6x50
4430047060	773 - 8x18	6x63
4430047062	773 - 10x20	6x65
4430047064	773 - 12x25	6x70
4430047066	773 - 16x25	6x70

### Conical

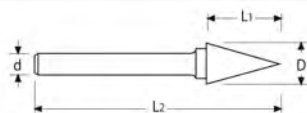

Code	Desc. D x L1	d x L2
4430047068	774 - 6x20	6x50
4430047070	774 - 8x18	6x63
4430047072	774 - 10x20	6x65
4430047074	774 - 12x25	6x70
4430047076	774 - 16x25	6x70

### Flame type

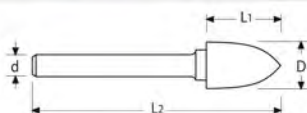

Code	Desc. D x L1	d x L2
4430047078	775 - 6x18	6x50
4430047080	775 - 8x18	6x63
4430047082	775 - 10x20	6x65
4430047084	775 - 12x25	6x70
4430047086	775 - 16x25	6x70

### Spherical

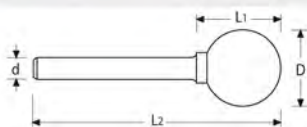

Code	Desc. D x L1	d x L2
4430047088	776 - 6x5	6x50
4430047090	776 - 8x7	6x52
4430047092	776 - 10x9	6x54
4430047094	776 - 12x10	6x55
4430047096	776 - 16x14	6x59

### Cylindrical with spherical head

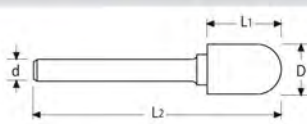

Code	Desc. D x L1	d x L2
4430047098	777 - 6x18	6x50
4430047100	777 - 8x18	6x63
4430047102	777 - 10x20	6x65
4430047104	777 - 12x25	6x70
4430047106	777 - 16x25	6x70

## Drop

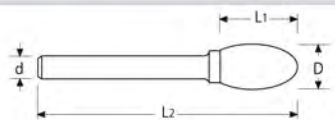

Code	Desc. D x L1	d x L2
4430047108	778 - 6x10	6x50
4430047110	778 - 8x13	6x58
4430047112	778 - 10x16	6x61
4430047114	778 - 12x20	6x65
4430047116	778 - 16x25	6x70

